

## LD-TRK-LPG1-3 - shallow recessed mounting extrusion

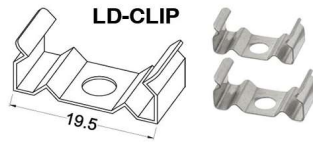

**LD-TRK-LPG1-3** - 3M (118.11") - designed for recessed mounting  
**LCUT-LPG1** - designed for recessed mounting, cut to exact length and mitre  
**LD-CLIP** - metal mounting clip sold in pairs (screws not included)  
**END CAPS NOT AVAILABLE**

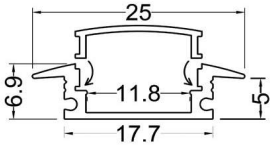

### Shallow recessed mounting extrusion

<b>Height</b>	6.9MM	<b>No. of Bulbs</b>	LED tape
<b>Width/Length</b>	17.7MM / 25MM		
<b>Body Material</b>	Aluminum	<b>Rated For Voltage</b>	Dry Location 12-24V
<b>Finish/Color</b>	Silver Anodized Aluminum		
<b>Type of Finish</b>	Anodized	<b>Approval Warranty</b>	cUL or equivalent 1 Year
		<b>Instal Position</b>	Any

Date:	Notes:
Fixture Type:	
Job Name:	



**Lighting • LED • Shades • Custom Designs**

TORONTO | BUFFALO | LIGHTFAIR | DALLAS MARKET CENTRE

[www.dainolite.com](http://www.dainolite.com)

1-888-564-1262

[dainolite@dainolite.com](mailto:dainolite@dainolite.com)

[/dainolite](https://www.facebook.com/dainolite)

[/dainoliteld](https://twitter.com/dainoliteld)

[/dainolite](https://www.instagram.com/dainolite)

