

LD-TRK-LPA1-3 - deep "U" extrusion

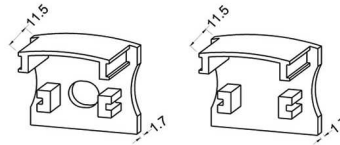

LD-TRK-LPA1-3 - 3M (118.11") - deep "U" extrusion
LCUT-LPA1 - deep "U" extrusion cut to exact length and mitre
LD-LPA1-EC - plastic end caps sold in pairs, friction fit
LD-CLIP - metal mounting clip sold in pairs (screws not included)

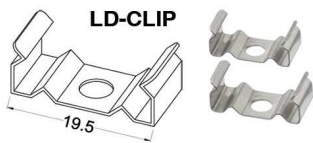
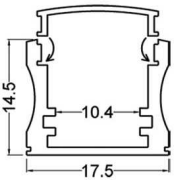

Deep "U" extrusion

Height	14.5MM	No. of Bulbs	LED tape
Width/Length	17.5MM		
Body Material	Aluminum	Rated For Voltage	Dry Location 12-24V
Finish/Color	Silver Anodized Aluminum	Approval	cUL or equivalent
Type of Finish	Anodized	Warranty	1 Year
		Instal Position	Any

Date:	Notes:
Fixture Type:	
Job Name:	



Lighting
LED
Shades
Custom Designs

TORONTO
|
BUFFALO
|
LIGHTFAIR
|
DALLAS MARKET CENTRE

www.dainolite.com

1-888-564-1262

dainolite@dainolite.com

/dainolite

/dainoliteld

/dainolite

